

Enjoy Boundless
Possibilities.

Follow us



Customer Support :
support@sunseekertech.eu

Website : sunseekerelite.com



Wireless Robotic
Mower 2026



CONTENT

About Sunseeker	01
Sunseeker Elite X9 Series	03
Sunseeker Elite X Gen 2 Series	13
Sunseeker Elite X4	20
Sunseeker Elite X Series	25
Accessories	36

GLOBAL FOOTPRINT



A PIONEER IN OUTDOOR INTELLIGENT ROBOTICS

The pioneer of intelligent outdoor solutions, leveraging cutting-edge robotics and human-centric design to provide a more effortless outdoor experience, rekindling our bond with nature.

MOMENTUM

2 MILLION+

OPE & Robots Units Output Annually

11

Global Branches

4

R&D Center

2

Industry-leading Labs

600+

Product Patents

400+

Engineers of 1700+ employees

TOP 3

Market share of Robot Mower Globally

WHO IS SUNSEEKER?

Sunseeker is a global leader in intelligent garden care, seamlessly blending tradition and technology to create efficient, user-friendly solutions.

As AI and robotics continue to flourish, Sunseeker actively exploring new AI-driven possibilities, continually expanding the boundaries of smart outdoor products and services. Guided by a commitment to continuous innovation, we pioneer new ways people interact with tools and nature-enabling everyone to embrace the beauty of the outdoors with greater ease and enjoyment.

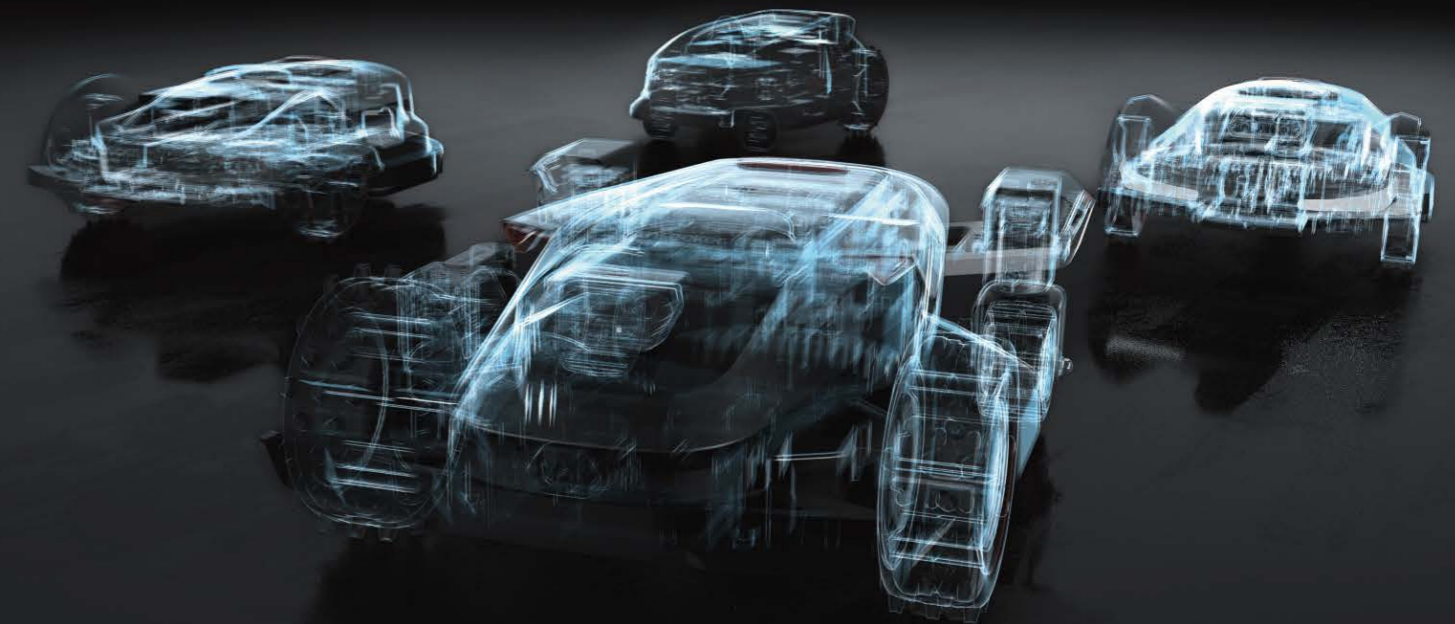

Built to Conquer

Designed for Big Yards / Sports Fields / Municipal gardens

- AONavi™ 2.0 Positioning & Navigation System
- No Antenna Setup, Truly Hands-Free
- 360° OmniSight™ Full Scene System
- 4WD+All-Wheel Independent Suspension System
- 90% / 42° Climbing Capacity
- 43 cm Dual Cutting Disc
- Fleet Management
- EdgeZero™ Cutting System



NetRTK

No Wire No Antenna Setup
Truly free your hands



No Antenna Station



VSLAM 2.0

The 10 TOPS chip allocates triple algorithm power to V-SLAM, enabling more precise localization. Even under RTK signal blockage, V-SLAM can maintain accurate positioning and path planning for up to **one hour**.



AONavi™ 2.0 Positioning & Navigation System

Fusion of nRTK and VSLAM 2.0

AONavi™ 2.0 requires no antenna station and comes standard with a 4G module, offering hassle-free outdoor operation. The newly upgraded 10 TOPS chip - 10 trillion operations per second helps the mower to be more responsive in mowing movements and obstacle avoidance.

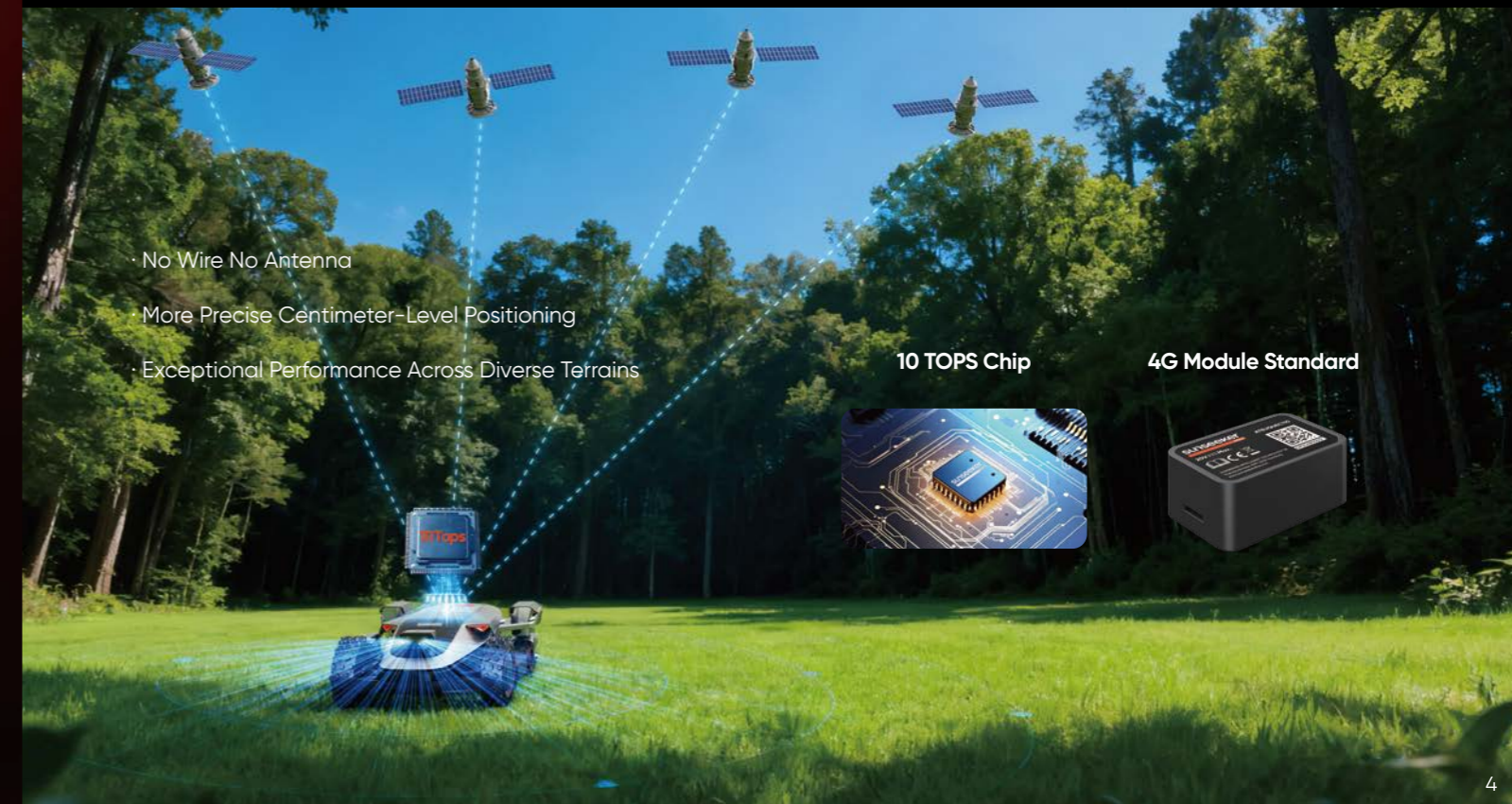

- No Wire No Antenna
- More Precise Centimeter-Level Positioning
- Exceptional Performance Across Diverse Terrains

10 TOPS Chip



4G Module Standard



360° OmniSight™ Full Scene System

8 Cameras Surrounding.

Day vision and night vision, brings **24h** vision & perception.

Binocular Camera
→ Day Vision



iToF Camera
→ Night Vision

Infrared
→ Thermal Vision



Side ToFView Camera
(iToF+RGBD)
→ For edge-trimming
obstacle avoidance.

dToF *2
→ Suitable for long -
distance measurement.



Total
16 Sensors
(including 8 cameras)

1
Charging
Infrared Sensor

1
Rain Sensor

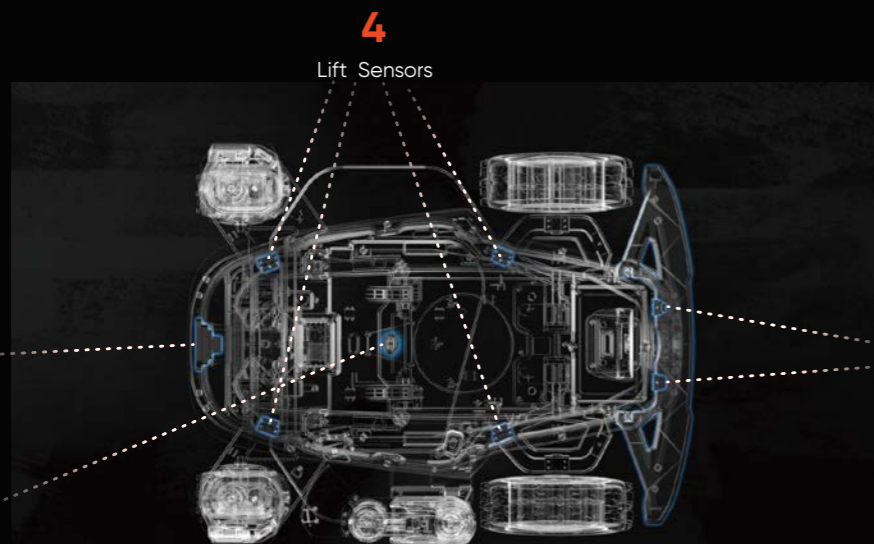

2
Collision Sensors

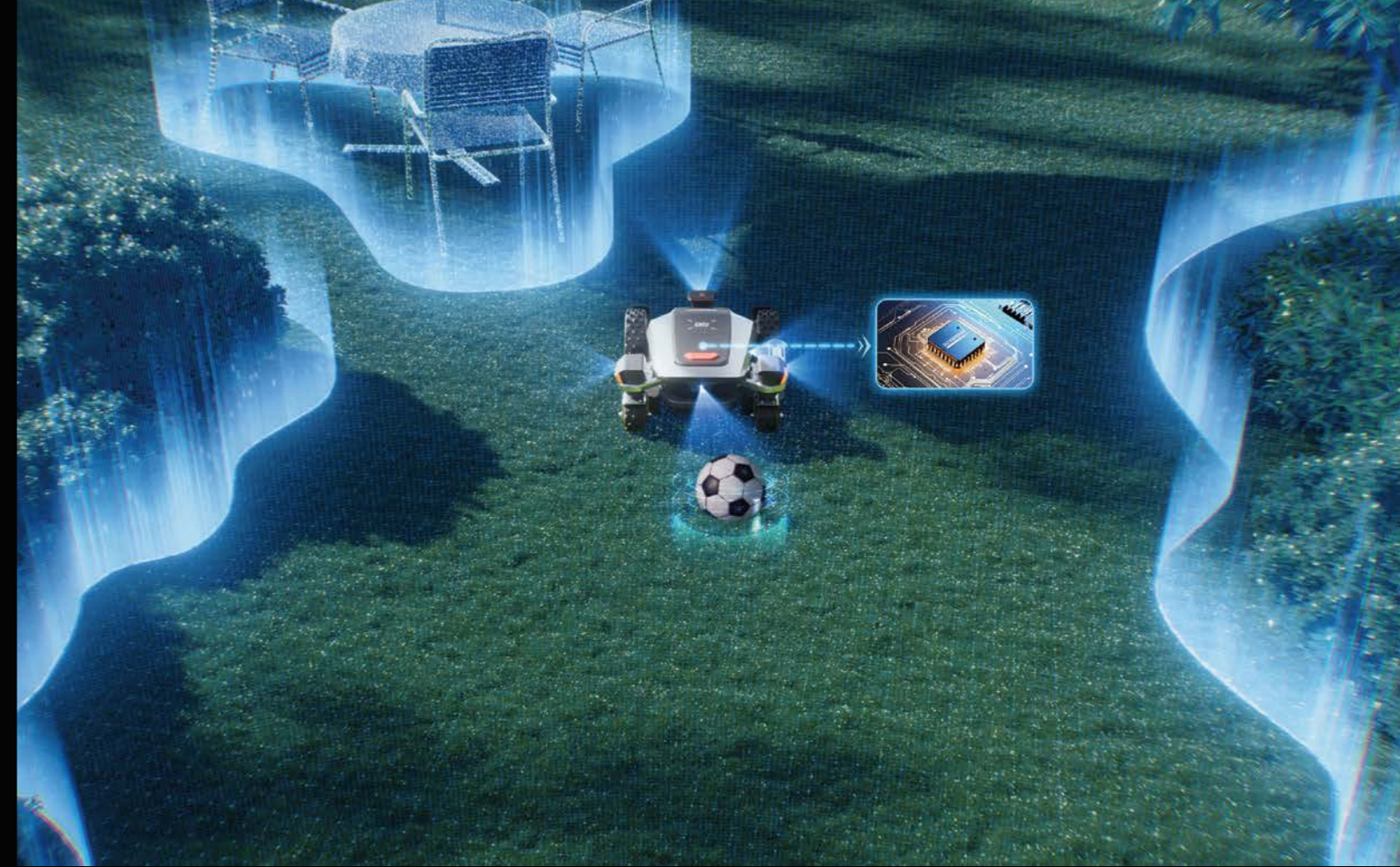

Sees more clearly.
Avoids more precisely.
Stays closer to edges.

Enhanced computing for the depth camera means sharper vision, smarter obstacle avoidance, perfect edge tracking, and a flawlessly clean lawn every time

24/7 Truly Animal Friendly

Experience seamless mowing with our 360° obstacle avoidance technology. Detect and avoid static, dynamic, and low-profile obstacles, even in low-light conditions. Our infrared system ensures animal-friendly navigation, spotting even **hidden animals**.





- 4** Wheel Drive (4WD)
- 2** Steering Motors
- 4** Wheel Suspension
- 2** 10" Front All-Terrain Wheels



The four-wheel drive structure of the X9 delivers a climbing ability that is first in the industry at **90% / 42°**

Stronger Performance with ATC Pro Drive System



Excellent Climbing Capacity is Second to None



Effortlessly Straight Cross Cuts – Even on the Steepest Slopes.

With the ATC Pro system, the X9 Series takes on rugged and slippery terrain with ease.

Superior Mowing System

- 190W** Ultra-Powerful Strong Magnetic Cutting Motor
- 43cm** Super Wide Dual Cutting Disc
- 6** Blades for each Disc
- 20-100 mm** Electric Cutting Height
- 4** Wheel Brushes



Cut - Before - Turn™

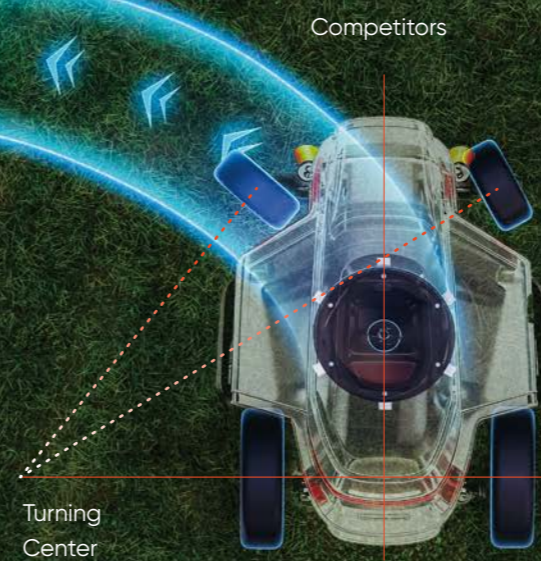
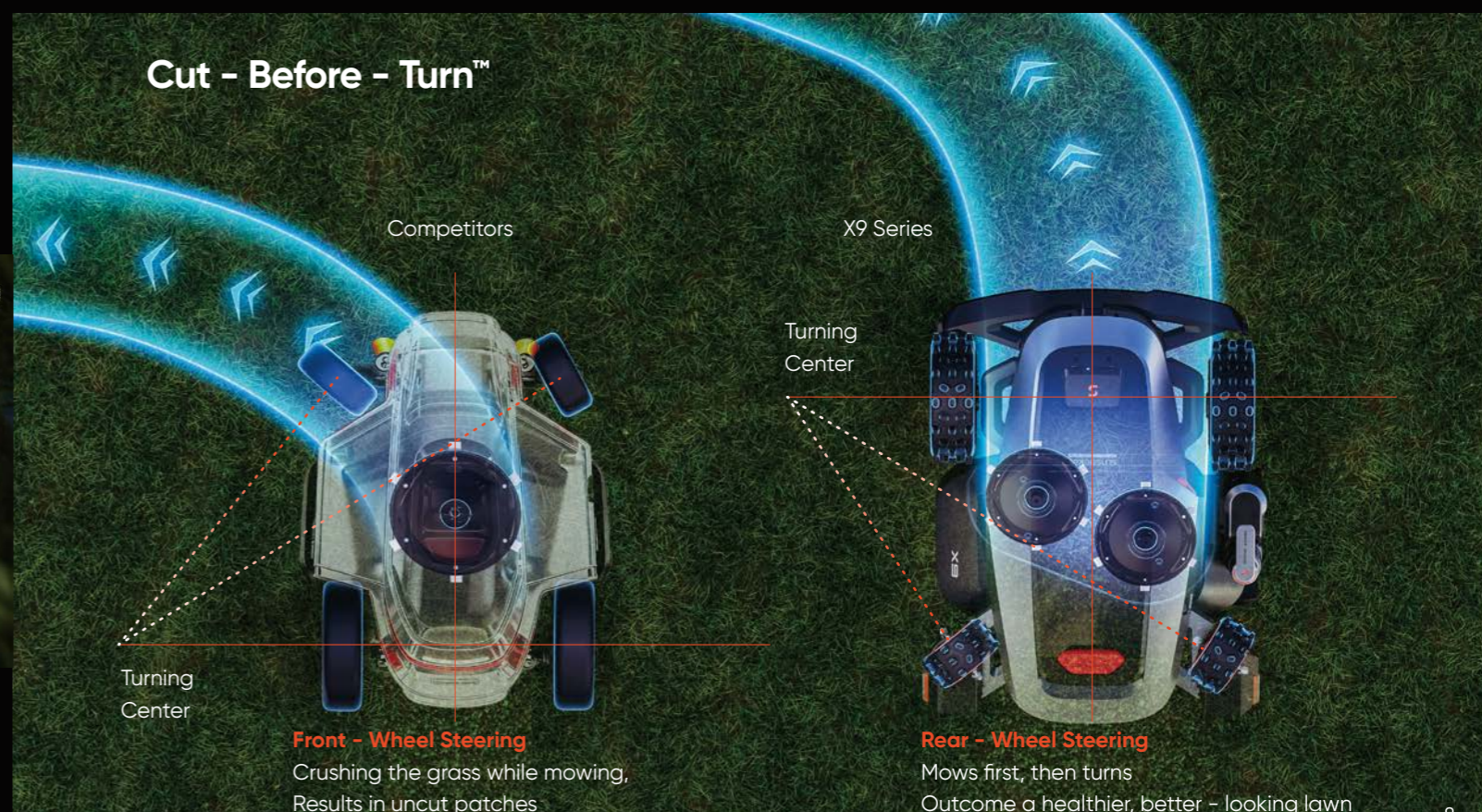

Front - Wheel Steering
Crushing the grass while mowing,
Results in uncut patches

X9 Series

Turning Center

Rear - Wheel Steering
Mows first, then turns
Outcome a healthier, better - looking lawn



Target Height Management
Unlimited Multi-zones

X9 0.6 m/s – X9+ 1 m/s Mowing Speed

Neater Edges with EdgeZero™ System

The EdgeZero™ trimming attachment for the X9 Series ensures zero-distance cutting at right angles in lawn areas, at the base of high fences, and in other boundary areas.

X9 : Optional

X9 Plus : Standard

0 Distance to the Edge



Automatic Obstacle Avoidance



Path Planning

Faster Charging with PioneerVolt™ Technology

Experience the next level of lawn care with our **42 V max,**
8 Ah super fast charging technology.

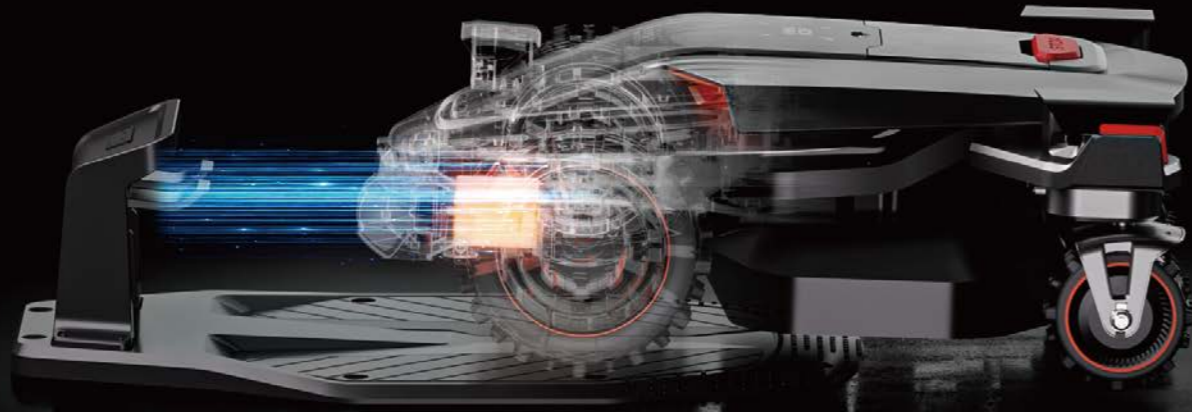

Fleet Management



It supplies a team- oriented solution, which leads to higher volume and more efficient management of large-scale landscapes.

Innovative Robotic Arm Coming Soon



The easily detachable robotic arm helps you pick up common garden obstacles such as tennis balls, stones, and small toys.



TECHNICAL SPECIFICATION	X9	X9 Plus
Positioning&NAV. Technology	AONavi™ 2.0(nRTK+VSLAM 2.0) 360° OmniSight™	AONavi™ 2.0(nRTK+VSLAM 2.0) 360° OmniSight™
Camera	Front Binocular + iToF + Infrared + Side ToFView Camera + dToF*2	Front Binocular + iToF + Infrared + Side ToFView Camera + dToF*2
Antenna Station	N	N
Max Area	12000 m ² / 48 hours	24000 m ² / 48 hours
Texture Map	Y	Y
Cutting Height	20-100 mm	20-100 mm
Cutting Width	43 cm	43 cm
Battery Capacity	8 Ah 42V	8 Ah 42V
Fast Charger	7 A	/
Flash Charger	/	Standard 17 A
Max Slope	90% / 42°	90% / 42°
Driving System	AWD/4WD	AWD/4WD
Speed	Max 0.6 m/s	Max 1 m/s
Noise Level	60 dB (A)	60 dB (A)
Waterproof	IPX6	IPX6
Dimensions	Trimmer Open 83*81*30.5 cm Trimmer Close 83*63.5*30.5 cm	Trimmer Open 83*81*30.5 cm Trimmer Close 83*63.5*30.5 cm
Weight	28 kg	30.3 kg
FEATURE		
Virtual Boundaries	Y	Y
Auto Mapping	Y	Y
Edge Trimmer	Optional	Standard
Obstacle Detection	Omni AI-ToF&Vision + Infrared	Omni AI-ToF&Vision + Infrared
Display	LCD	LCD
Floating Bumper	Y	Y
Ride-on Boundary Cutting	Y	Y
Automatic Path Planning	Y	Y
Floating Cut Disc	Y	Y
Height Adjustment	Electric	Electric
Multi-zones	No limit	No limit
Schedule Setting	Y	Y
Rain Sensor	Y	Y
Atmosphere&Function Light	Y	Y
Warning Light	Y	Y
Night Mode	Y	Y
Connectivity	Wifi/Bluetooth/4G	Wifi/Bluetooth/4G
nRTK 4G module + Anti-theft	5 Years Standard	5 Years Standard
FOTA	Y	Y
Alexa or Google Home	Y	Y

sunseeker elite X5 Gen 2/ X7 Gen 2/ X7 Plus Gen 2

Conquering Your Lawn, Smarter Than Ever

Full-Scenario Navigation



nRTK + VSLAM 2.0

Day & Night Operation



Binocular Camera + iToF Camera

All-Terrain Conquer



3WD / Front Suspension / Steering Motor

sunseeker elite X7 Gen 2/ X7 Plus Gen 2

3000 m² / 6000 m²

- Max climbing capacity up to 70%
- Cutting width 35 cm. (Dual disc)
- Electronic cutting height adjustment 20-100 mm



sunseeker elite X5 Gen 2

2000 m²

- Max climbing capacity up to 60%
- Cutting width 22 cm
- Manual cutting height adjustment 20-60 mm



Full-Scene Positioning AONavi™ 2.0 Positioning & Navigation System

Fusion of nRTK and VSLAM 2.0

AONavi™ 2.0 requires no antenna station and comes standard with a 4G module, offering hassle-free outdoor operation.



10 TOPS Chip



4G Module Standard

- No Wire No Antenna Setup
- More Precise Centimeter-Level Positioning
- Exceptional Performance Across Diverse Terrains

24h Vision & Obstacle Avoidance Vision AI 2.0

Upgraded Vision AI 2.0 technology ensures visual obstacle avoidance during the day by **binocular camera**, while **iToF** guarantees visual obstacle avoidance at night, thus forming 24/7 precise obstacle avoidance.



iToF

Binocular Camera

24/7 precise obstacle avoidance.

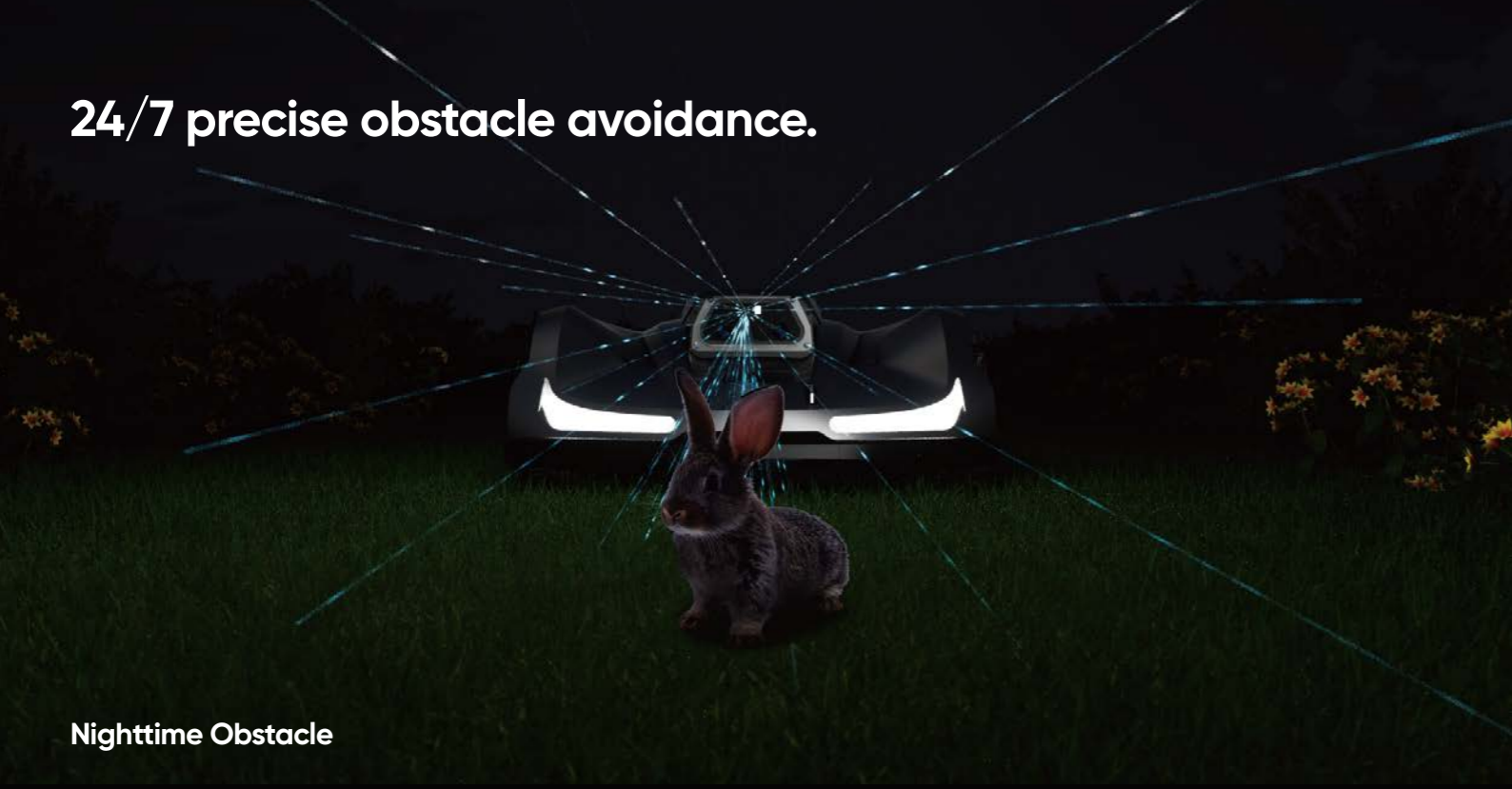

Nighttime Obstacle



Daytime Obstacle



Closer to the Obstacle

All-Terrain Conquer ATC System

3 Wheel Drive (AWD)
Front Wheel Suspension

Rear Steering Motor
Up to 70% / 35° Climbing Capacity



All-Terrain Wheels
For X Gen 2 Series



Wheel Brush
For X5 Gen 2 / X7 Gen 2 / X7 Plus Gen 2

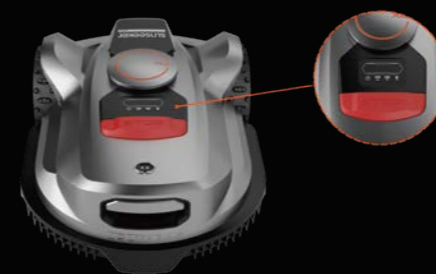

LCD Display



6 Blades per Disc

X5 Gen 2 Precise Edge Cutting Disc Cut to the edge ≤3 cm



sunseeker X3 Gen 2 elite

800 m²

- Max climbing capacity up to 30%
- Cutting width 20 cm
- Manual cutting height adjustment 20-60 mm



- **nRTK**
- **10 TOPS Chip**
- **4G Standard**

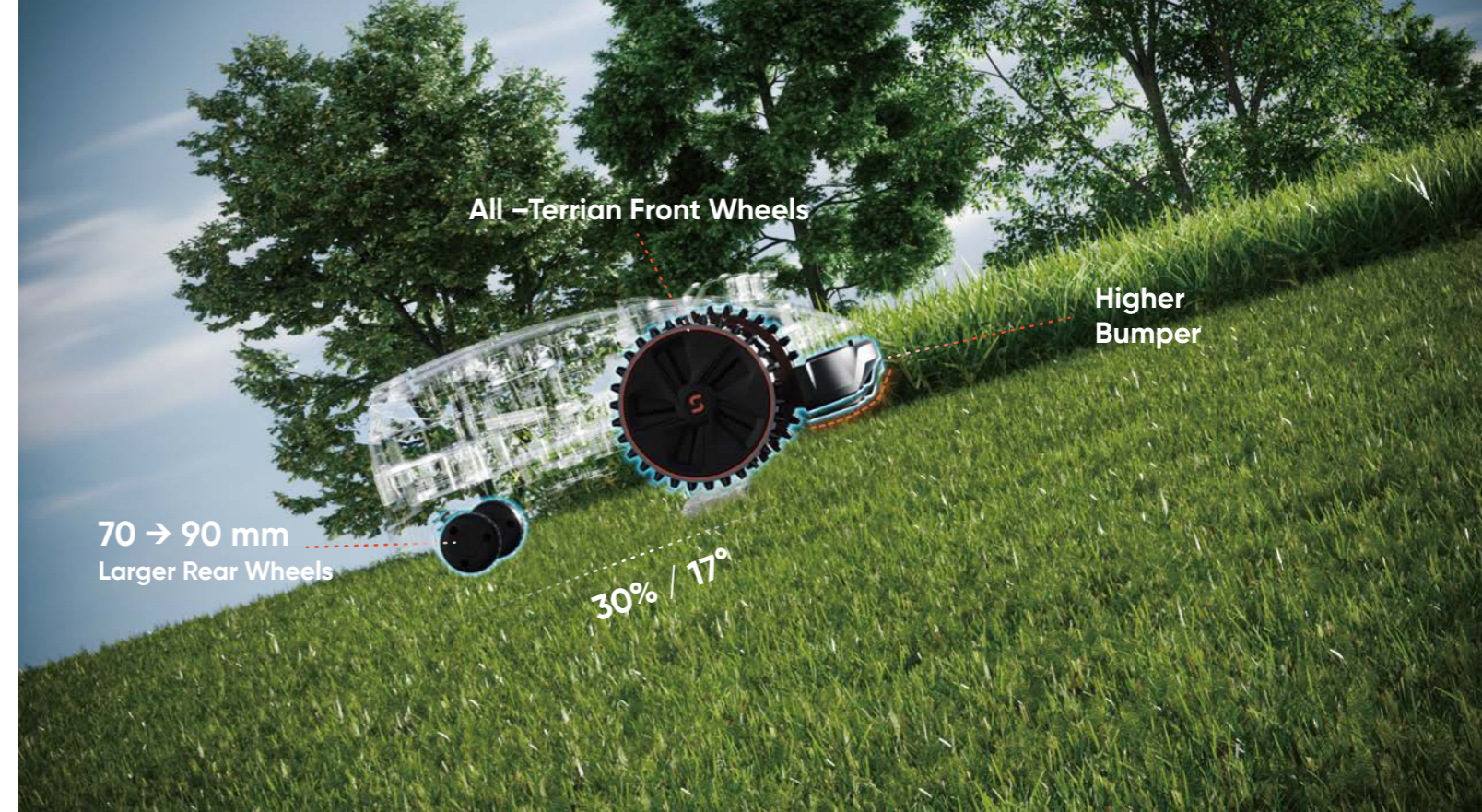

X3 Gen 2 Precise Edge Cutting Disc
Cut to the edge ≤ 3 cm



TECHNICAL SPECIFICATION	X3 Gen 2	X5 Gen 2	X7 Gen 2	X7 Plus Gen 2
Area	800 m ²	2000 m ²	3000 m ²	6000 m ²
Technology	AONavi 2.0 (nRTK+VSLAM) Vision AI	AONavi 2.0 (nRTK+VSLAM 2.0) Vision AI 2.0 (Binocular+iToF)	AONavi 2.0 (nRTK+VSLAM 2.0) Vision AI 2.0 (Binocular+iToF)	AONavi 2.0 (nRTK+VSLAM 2.0) Vision AI 2.0 (Binocular+iToF)
Vision	Day vision	Day vision + Night vision	Day vision + Night vision	Day vision + Night vision
Camera	Binocular	Binocular + iToF	Binocular + iToF	Binocular + iToF
nRTK 4G module + Anti-theft	Y (2 Years Free)	Y (2 Years Free)	Y (2 Years Free)	Y (5 Years Free)
Drive	Front-wheel drive	AWD & Steering rear wheel	AWD & Steering rear wheel	AWD & Steering rear wheel
Max Slope	30% / 17°	60% / 30°	70% / 35°	70% / 35°
Suspension	N	Front wheel suspension	Front wheel suspension	Front wheel suspension
Cutting Height	20-60 mm	20-60 mm	20-100 mm	20-100 mm
Height Adjustment	Manual	Manual	Electronic	Electronic
Cutting Width	20cm	22 cm	35 cm (Dual disc)	35 cm (Dual disc)
Cutting Blades	3 Blades	6 Blades	6 Blades*2	6 Blades*2
Battery Capacity	5 Ah (EVE)	5 Ah (Samsung)	10 Ah (Samsung)	10 Ah (Samsung)
Charger	2 A	3 A	5 A	7 A
Waterproof	IPX5	IPX5	IPX5	IPX5
Cutting Speed	Max 0.45m/s	Max 0.45m/s	Max 0.45m/s	Max 0.45m/s
Noise Level	60dB (A)	60dB (A)	60dB (A)	60dB (A)
Dimensions	60.8*38.0*25 cm	68.0*42.5*26 cm	74.1*51.3*26.7 cm	74.1*51.3*26.7 cm
Weight	9.0 kg	12.0 kg	14.3 kg	14.4 kg

FEATURE	X3 Gen 2	X5 Gen 2	X7 Gen 2	X7 Plus Gen 2
Virtual Boundaries	Y	Y	Y	Y
Intelligent Path Planning	Y	Y	Y	Y
Obstacle Detection	Vision AI + Bumper	Vision AI 2.0+ Bumper	Vision AI 2.0+ Bumper	Vision AI 2.0+ Bumper
Floating Cut Disc	Y	Y	Y	Y
Display	LED	LCD	LCD	LCD
Auto Mapping	N	Y	Y	Y
Ride-on Boundary Cutting	Y	Y	Y	Y
Customized Multi-angle Cutting	Y	Y	Y	Y
Spot Mowing	Y	Y	Y	Y
Efficiency Mode	N	Y	Y	Y
Multi-zones	No limit	No limit	No limit	No limit
Connectivity	Wifi/Bluetooth/4G	Wifi/Bluetooth/4G	Wifi/Bluetooth/4G	Wifi/Bluetooth/4G
Night Mode	N	Y	Y	Y
Rain Sensor	Y	Y	Y	Y
FOTA	Y	Y	Y	Y
Alexa or Google Home	Y	Y	Y	Y
LED Headlight	N	Y	Y	Y
Accessories-Brush	Brush Kit	Brush Kit	Brush Kit	Brush Kit

sunseeker X4 elite

1200 m²

- LidarAI™ 3D Fusion Sensing System
- No Wire No Antenna , Drop & Go
- AI Powered Automatic Lawn Mapping
- Smart Path Planning
- 3D Omnidirectional Obstacle Avoidance
- Smart Zone Control with One Mower
- 45% /24° Climbing Capacity
- Industry-Leading 10 TOPS AI Chip



Perceiving the Environmental in Real-Time Detail

Equipped with a 360° 3D LiDAR offering an effective resolution of 172 lines, the LiDAR scans at 6,000 rpm , covering a 360° (H) × 70° (V) field of view while generating up to 210,000 points per second. This results in an extremely dense point cloud.



Delivers richer, more detailed, and real-time environmental perception.

1+1 > 2 : The Power of LidarAI™ 3D Fusion Sensing System



Drop & GO

No Wire No Antenna
1 min Quick Start

- Complementary Perception
- Work Day and Night
- Superior Adaptability



Nighttime

- Floating Obstacle Avoidance: trampoline, balloon...
- Static Obstacle Avoidance: Chairs...
- Dynamic Obstacle Avoidance: Pets, Human...



Daytime

AI Powered Automatic Lawn Mapping

Goodbye to the hassle of Antenna installation and Boundary setup! X4 can start mowing right after being placed on your lawn. It is capable of quickly setting up virtual boundaries and achieving highly efficient, fully automatic lawn mapping, it will build a detailed 3D map of your lawn in real time.



3D Map

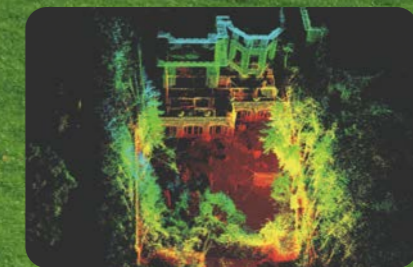

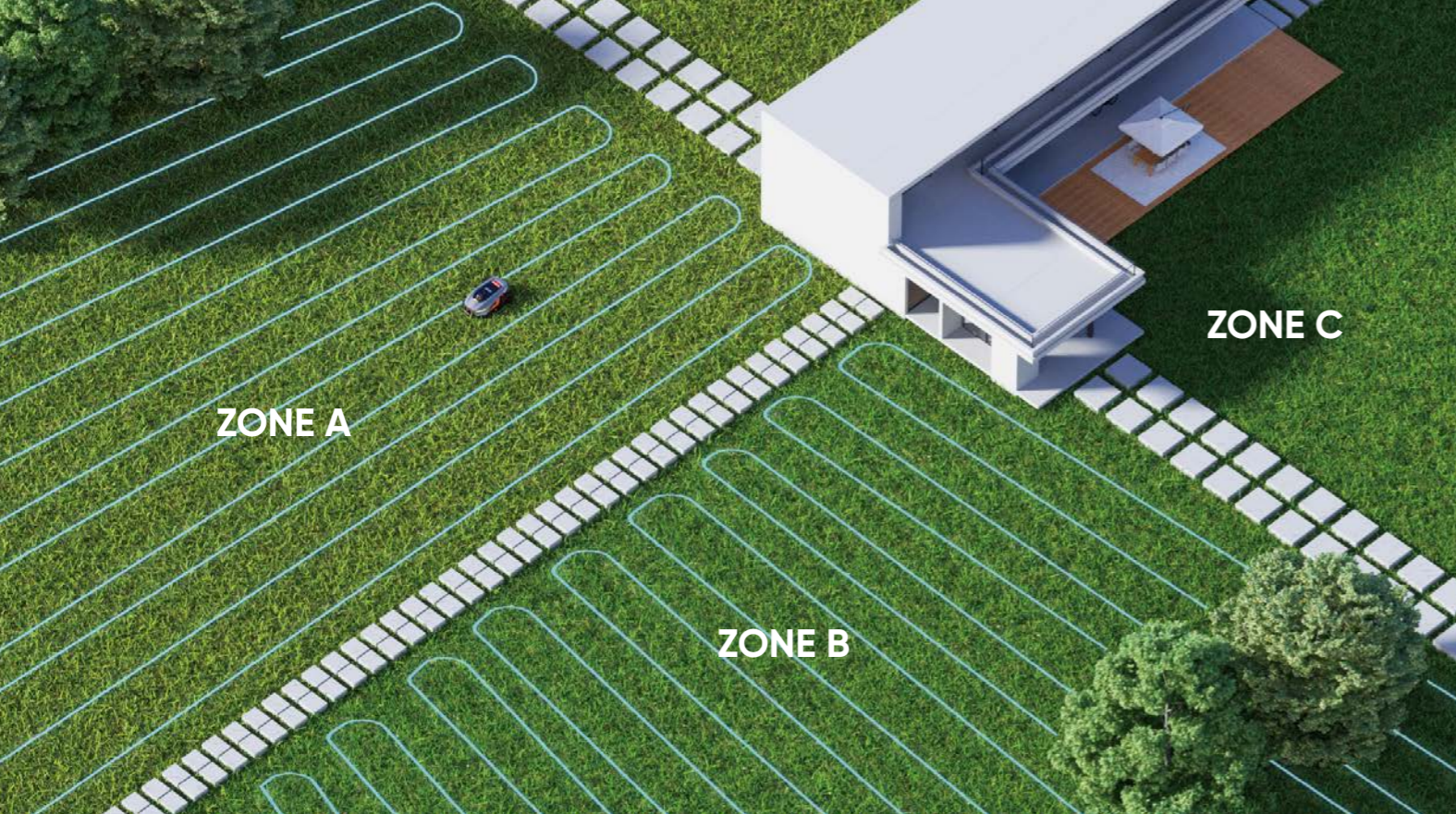

Smart Path Planning for Efficient Mowing

Equipped with advanced Lidar sensor, X4 maps your lawn with millimeter-level accuracy. It is capable of planning the most efficient mowing paths to ensure that every blade of grass is evenly trimmed.

Rear-wheel drive + Suspension System

Rear-wheel drive enables easy handling of slopes up to 45% / 24°, and the rear suspension improves the X4's ability to navigate rough terrain, facilitating easy escape from difficult situations.



Standard Anti-theft module (4G & GPS)

Feel secure knowing that the X4 standard Anti-Theft feature has got your back. With GPS and 4G technology, it offers top-notch location tracking to keep your mower safe and sound.

LCD Display

The LCD can provide clear and delicate image and text display. Under various environmental conditions, the LCD display can maintain stable performance and is not easily affected by factors such as temperature and humidity.

X4

TECHNICAL SPECIFICATION

Area	1200 m ²
Technology	360° 3D LiDAR + Vision AI (L - SLAM)
Vision	Day vision
Camera	Monocular
4G module + Anti-theft	Y (2 Years Free)
Drive	Rear-Wheel Drive
Max Slope	45% / 24°
Suspension	Rear wheel suspension
Cutting Height	20-60 mm
Height Adjustment	Manual
Cutting Width	20 cm
Cutting Blades	6 Blades
Battery Capacity	5 Ah
Charger	3 A
Waterproof	IPX6
Cutting Speed	Max 0.45m/s
Noise Level	60dB (A)
Dimensions	63.75 * 42.16 * 27.43 cm
Weight	12 kg

FEATURE

Virtual Boundaries	Y
Intelligent Path Planning	Y
Obstacle Detection	360° Lidar + Vision AI + Bumper
Floating Cut Disc	Y
Display	LCD
Auto Mapping	Y
Ride-on Boundary Cutting	Y
Customized Multi-angle Cutting	Y
Spot Mowing	Y
Efficiency Mode	Y
Multi-zones	No limit
Connectivity	Wifi/Bluetooth/4G
Super WIFI	N
Night Mode	Y
Rain Sensor	Y
FOTA	Y
Alexa or Google Home	Y
LED Headlight	Y
Accessories-Brush	Brush Kit

sunseeker X Series

elite

The Ultimate Mowing Solution



AONavi™ Positioning and Navigation System

Full-band RTK and VSLAM keeps the mower always on duty, mapping smoothly—no wires, no limits



Vision AI

Binocular camera with leading algorithm for precise obstacle avoidance



Floating Cut System

Smooth traverse on uneven ground



All-Wheel Drive

Climbing ability 70% / 60%
*X7 / X5



sunseeker X7 elite 3000/6000 m²

- Max climbing capacity up to 70%
- Cutting width 35 cm (Dual disc)
- Electronic cutting height adjustment 20-100 mm



sunseeker X5 elite 2000 m²

- Max climbing capacity up to 60%
- Cutting width 22 cm
- Manual cutting height adjustment 20-60 mm



AONavi™ Positioning and Navigation System

The Sunseeker Elite AONavi™ Positioning and Navigation System combines Real-Time Kinematic (RTK) satellite positioning technology with VSLAM visual navigation that ensures accurate boundary setting and work routes regardless of obstacles or the unique shape of your lawn.





Advanced Wire-Free Virtual Mapping

Simply walk the mower around the desired work zone, and the system automatically recognizes and sets the virtual boundaries in real-time



Multi-Zone Management

Zone A

Zone B

No-go Zone

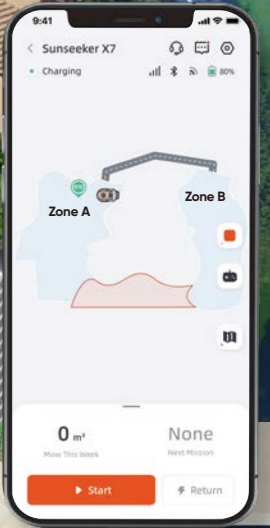

Full Map



Intelligent Path Planning

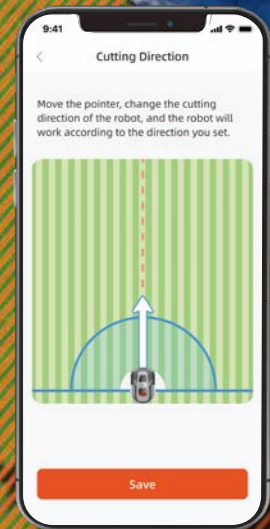

Vision AI Technology

Equipped with 3D binocular camera, the X Series Vison AI technology excels in perceiving the surrounding environment and navigating obstacles seamlessly. Supported by our proprietary deep learning algorithms, it consistently enhances its comprehension of landscapes through continuous data accumulation .



Accurate Environmental Perception

3D Depth Perception helps the X Series mowers to differentiate between objects at varying distances, reducing the risk of collisions.

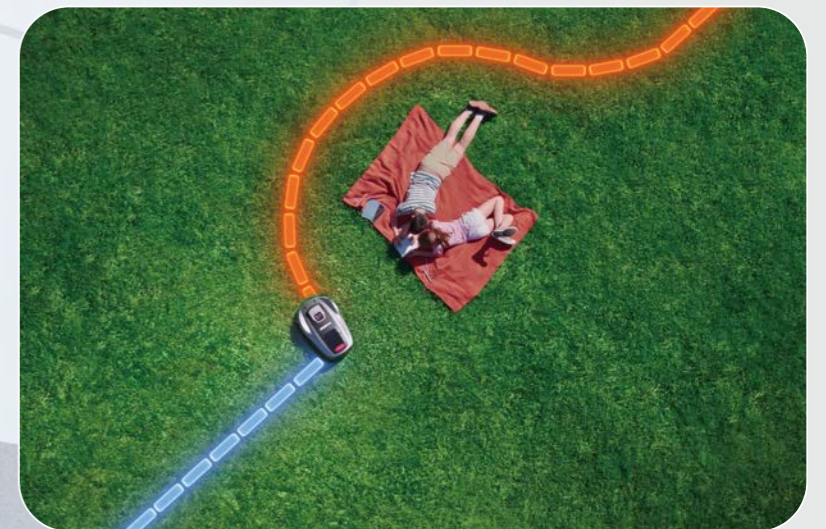

Automatic Obstacle Avoidance

Vision AI and deep-learning empower X mower to recognize a greater variety of species, up to 200 types.

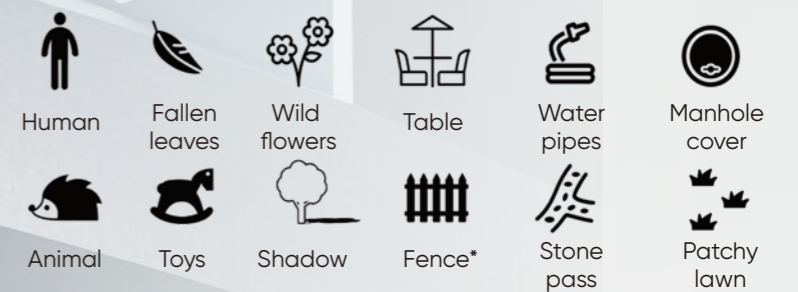

*Please ensure that AI Sensitivity is set to Normal mode.

Gentle on Turf

Care for your garden as much as you do



Steering Motor For Smart Turning & Soft Friction to Grass

X7

Floating Cut System for Uneven Terrain

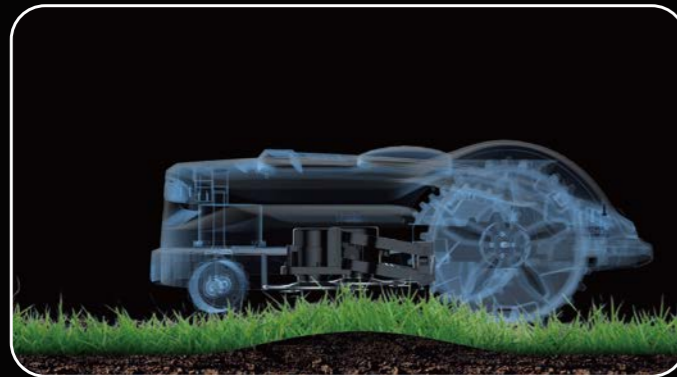

Electronic adjustable Cutting Height from 20 - 100 mm



Lawn Trimming and Scarifying in One Step

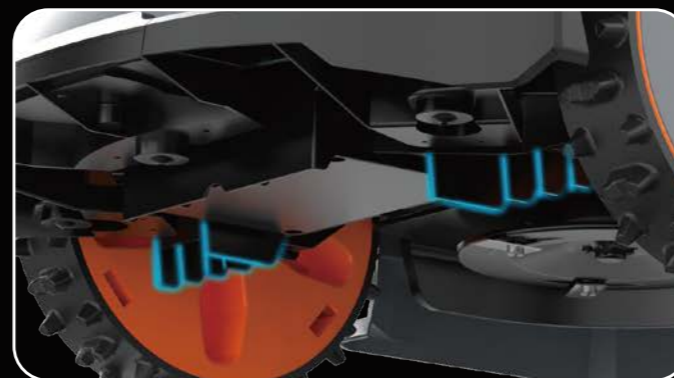

35 cm

The X Series All-Wheel Drive System

X7's powerful all-wheel drive system can traverse slopes with up to a 70% incline and can handle rough and uneven terrain, tree roots, and pathways.

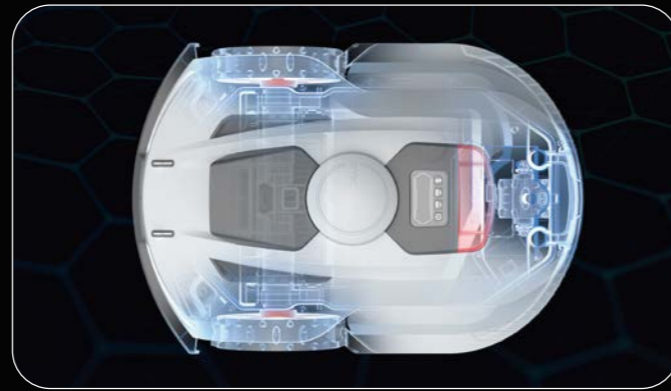

Climbing ability 70%(35°) / 60%(30°)
*X7 / X5

Steering Motors



Steep Slopes

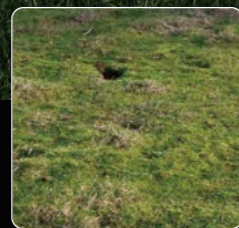

Potholes



Rough Terrain

Control with Ease Secure with Confidence

Sunseeker Smart App

Enjoy a user-friendly experience via the Sunseeker Smart App, which offers seamless smart home integration and remote control of your mower.

- Multi-zone Management
- Path Planning
- Schedule Settings
- Status Monitoring
- Height Adjustment

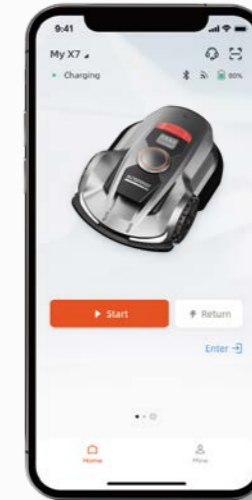

LoRa Wi-Fi Connection



The X Series features a wireless transceiver module with an impressive signal transmission range of 200 metres.

4G & GPS Module (optional feature)

Feel secure knowing that the X series optional Anti-Theft feature has got your back. With GPS and 4G technology, it offers top-notch location tracking to keep your mower safe and sound. Additionally, the 4G module can provide data when the robot lacks Wi-Fi, ensuring the robot's connection to the server even when the mower is powered off.





TECHNICAL SPECIFICATION	X5	X7	X7 Plus
Area	2000 m ²	3000 m ²	6000 m ²
Technology	AONavi(RTK+VSLAM) Vision AI	AONavi(RTK+VSLAM) Vision AI	AONavi(RTK+VSLAM) Vision AI
Vision	Day vision	Day vision	Day vision
Camera	Binocular	Binocular	Binocular
4G module + Anti-theft	Optional	Optional	Y (2 Years Free)
Drive	AWD & Steering rear wheel	AWD & Steering rear wheel	AWD & Steering rear wheel
Max Slope	60% / 30°	70% / 35°	70% / 35°
Suspension	Front wheel suspension	Front wheel suspension	Front wheel suspension
Cutting Height	20-60 mm	20-100 mm	20-100 mm
Height Adjustment	Manual	Electronic	Electronic
Cutting Width	22 cm	35 cm (Dual disc)	35 cm (Dual disc)
Cutting Blades	3 Blades	3 Blades*2	3 Blades*2
Battery Capacity	5 Ah (Samsung)	10 Ah (Samsung)	10 Ah (Samsung)
Charger	3 A	5 A	7 A
Waterproof	IPX5	IPX5	IPX5
Cutting Speed	Max 0.45m/s	Max 0.45m/s	Max 0.45m/s
Noise Level	60dB (A)	60dB (A)	60dB (A)
Dimensions	68.0*42.5*26 cm	68.0*42.5*26 cm	68.0*42.5*26 cm
Weight	12 kg	14.3 kg	14.4 kg
FEATURE			
Virtual Boundaries	Y	Y	Y
Intelligent Path Planning	Y	Y	Y
Obstacle Avoidance	Vision AI + Bumper	Vision AI + Bumper	Vision AI + Bumper
Cut Over the Border	Y	Y	Y
Floating Cut Disc	Y	Y	Y
Display	LED	LED	LED
Auto Mapping	N	N	N
Ride-on Boundary Cutting	Y	Y	Y
Customized Multi-angle Cutting	Y	Y	Y
Spot Mowing	Y	Y	Y
Efficiency Mode	Y	Y	Y
Multi-zones	No limit	No limit	No limit
Connectivity	Wifi/Bluetooth	Wifi/Bluetooth	Wifi/Bluetooth/4G
Super WIFI	Y	Y	Y
Night Mode	Y	Y	Y
Rain Sensor	Y	Y	Y
FOTA	Y	Y	Y
Alexa or Google Home	Y	Y	Y
LED Headlight	Y	Y	Y
Accessories-Brush	N	N	N

Accessories

Garage

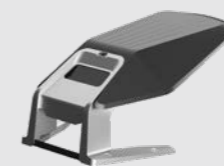

Gliding Disc

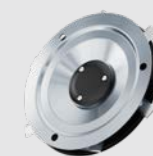

Garage (For X4)



Wheel Brush (2pcs/set)



S Connect Module (2026 Version)

Include 2 years data & anti-theft function



Decorative Sticker



Antenna Wall Mount



Heavy-Duty Fixed Blades [Commercial Use]



Rotary Antenna Support Attachment



Grass Cleaning Brush



Antenna Ground Mount



Artificial Turf (Putting in front of charging station)



Solar Power Kit for Antenna (no include Antenna)



Extension Cable 10m



Standard Blades kit (24pcs)



Rechargeable Battery Pack



Premium Blades kit (24pcs)



Antenna Kit

